

Documentation Zimbra

Prérequis :

- Ubuntu Server
- Infrastructure reseau (PfSense, Contrôleur de Domaine...)

1 – Architecture Reseau :

Eléments	Valeur
Domaine de messagerie	Biovison.com
IP Serveur Zimbra (Ubuntu)	172.20.0.14
IP Contrôleur de Domaine (AD)	172.20.0.10
IP Passerelle (pfSense)	172.20.0.1
DNS Primaire	172.20.0.10

2 – Configuration DNS Domain Controller

- Crée le serveur de messagerie :

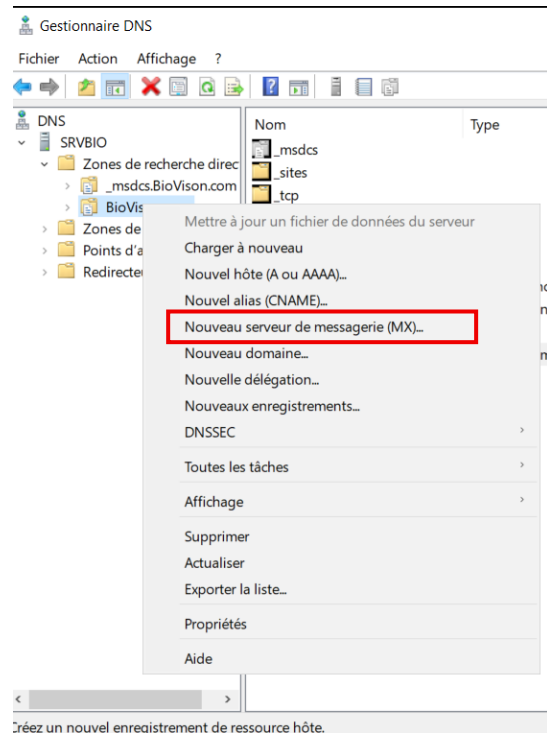

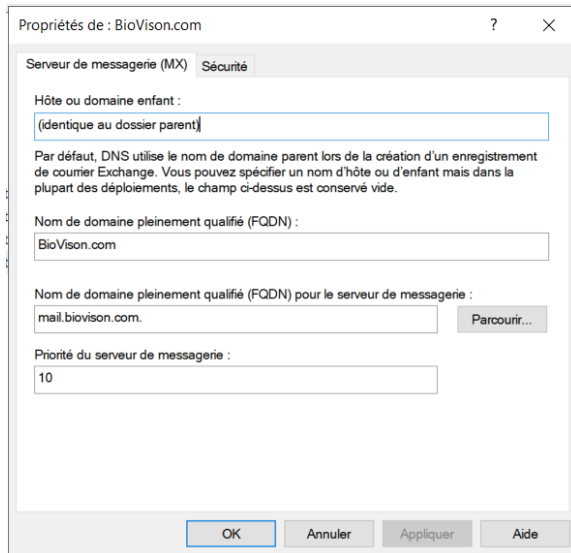

- Crée ensuite l'hôte :

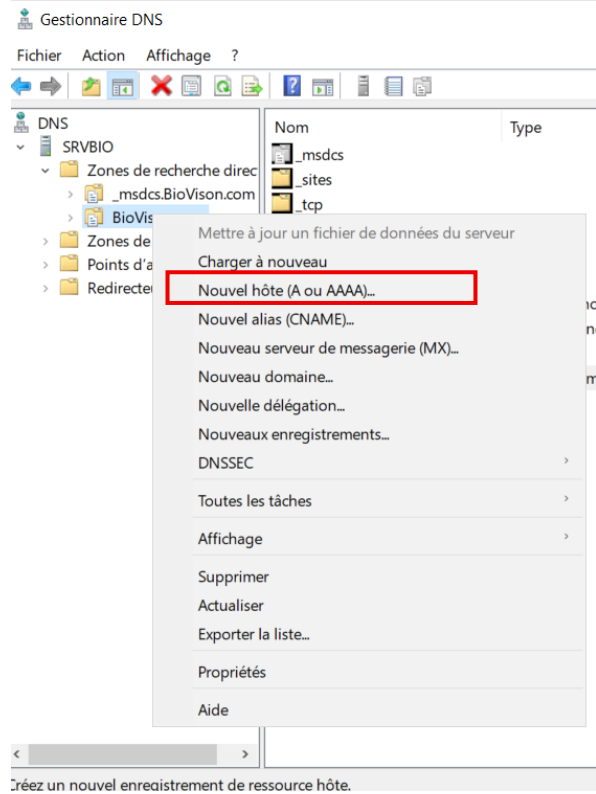

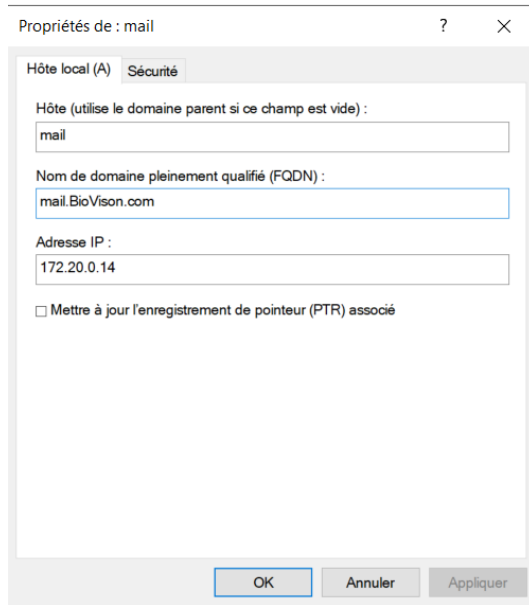

3 – Préparation Du Système Ubuntu

A – Configuration du fichier `/etc/hosts`

- Permet a Zimbra de s'identifier lui-même, en rajoutant la ligne : **172.20.0.14 mail.biovison.com mail**

```
GNU nano 4.8 /etc/hosts
127.0.0.1 localhost
172.20.0.14 mail.biovison.com mail

# The following lines are desirable for IPv6 capable hosts
::1 ip6-localhost ip6-loopback localhost
fe00::0 ip6-localnet
ff00::0 ip6-mcastprefix
ff02::1 ip6-allnodes
ff02::2 ip6-allrouters
```

B – Configuration DNS

- Configuration du réseau avec le fichier `/etc/netplan/00-installer-config.yaml`

```

GNU nano 4.8 /etc/netplan/00-installer-config.yaml
# This is the network config written by 'subiquity'
network:
  version: 2
  renderer: networkd
  ethernets:
    ens37:
      addresses:
        - 172.20.0.14/24
      nameservers:
        addresses: [172.20.0.10, 8.8.8.8]
      routes:
        - to: default
          via: 172.20.0.1

```

- Application des changements : `sudo netplan apply`

4 – Installation de Zimbra

- Mise à jour des dépôts et des paquets
- Téléchargement de Zimbra :
`wget https://files.zimbra.com/downloads/8.8.15_GA/zcs-8.8.15_GA_3869.UBUNTU20_64.20200918190226.tgz`
- Extraction de l'archive `tar -zxvf <>`
- Lancement de `install.sh`, qui lance l'installation de tous les paquets requis.
- Création de `admin@biovison.com`

5 – Configuration de Zimbra

- URL Administration : `https://172.20.0.14:7071`
- Création d'un compte test :

Home - Manage - Accounts - testmail1@biovison.com		ID:	c1fb0991-ca0e-44a2-a7f9-7914519e2db3
mail1		Created:	March 4, 2026 9:51:07 AM
Email: testmail1@biovison.com		Server:	mail.biovison.com
Quota: 0.002 MB of unlimited		Status:	Active
		Last Login:	March 4, 2026 9:59:42 AM
▼ Account Name			
Account name:*	testmail1	@	biovison.com
First name:			
Middle initial:			
Last name:*	mail1		
Display name:	mail1	<input checked="" type="checkbox"/>	auto
Hide in GAL:	<input type="checkbox"/>		

- Test d'envoi de mail entre `admin@biovison.com` et `testmail1@biovison.com` :

admin@biovison.com

test 1 message

From: admin@biovison.com
To: "mail1" <testmail1@biovison.com>

March 4, 2026 9:57 AM

ttttttttttttteest

Reply - Reply to All - Forward - More Actions

mail1

test 1 message

From: admin@biovison.com
To: "mail1" <testmail1@biovison.com>

March 4, 2026 9:57 AM

ttttttttttttteest

Test réussi !

- Connexion a l'AD :

Home - Configure - Domains - biovison.com - Authentication

biovison.com

ID: b8c34f54-79ab-4c00-8ec9-dc7e34c0f02
Created: March 4, 2026 9:38:17 AM
Status: Active

▼ Authentication Setting

Authentication mechanism:	External LDAP
LDAP bind DN template:	
LDAP URL:	ldap://172.20.0.10:389
Enable StartTLS:	
LDAP filter:	(sAMAccountName=%u)
LDAP search base:	dc=biovison,dc=com
Use DN/Password to bind to external server:	Yes
Bind DN:	administrateur@biovison.com
External password change listener:	
<input type="checkbox"/>	If fail, fall back to local password management